



# Mississippi Well Owner Network WATER SAMPLE FORM

Please print clearly and complete all pages of this form.

Date collected: \_\_\_\_/\_\_\_\_/\_\_\_\_ County: \_\_\_\_\_ Email: \_\_\_\_\_

Name: \_\_\_\_\_ Telephone: (\_\_\_\_) \_\_\_\_\_

Mailing Address: \_\_\_\_\_  
Street address City Zip

Sample Location Address (if different from mailing address):

\_\_\_\_\_ Street address City Zip

Marking instructions

CORRECT ● INCORRECT ○○○○

Sample ID #:

By providing a water sample to be screened through the Mississippi Well Owner Network program, I acknowledge that the analysis results may be used for research and summary purposes.

## WATER WELL SAMPLE

1. What is the primary use for your water well?

- domestic/household use     livestock     irrigation     other

2. What type of well do you have?

- a.  dug or bored well     drilled well     don't know

b. What is the well's depth? \_\_\_\_\_ feet     don't know

c. What year was the well constructed? \_\_\_\_\_     don't know

3. What water treatment devices are currently installed? (Fill in all that apply.)

- none     iron removal     water softener (conditioner)     other (specify): \_\_\_\_\_  
 ultraviolet (uv) light     chlorinator     reverse osmosis  
 sediment filter     acid neutralizer     activated carbon (charcoal) filter

4. Your primary place of residence?

- rural property < 10 acres     farm or ranch > 100 acres     town or city between 3,300 and 10,000  
 farm or ranch 10-100 acres     town under 3,300     city between 10,000 and 50,000  
 city over 50,000

5. Please complete one line for each of the members of your household.

Gender <i>fill in one</i>	Age <i>fill in one</i>	Level of Education Completed <i>fill in one</i>	What race/ethnicity best describes this person? <i>fill in one</i>	Has this person had stomach upset in the past month?	Does this person drink water from the well or spring?
<input type="radio"/> Male <input type="radio"/> Female	<input type="radio"/> < 1 <input type="radio"/> 21-30 <input type="radio"/> 1-5 <input type="radio"/> 31-40 <input type="radio"/> 6-10 <input type="radio"/> 41-50 <input type="radio"/> 11-15 <input type="radio"/> 51-60 <input type="radio"/> 16-20 <input type="radio"/> 61+	<input type="radio"/> In school now <input type="radio"/> Some high school <input type="radio"/> High school grad <input type="radio"/> Some college <input type="radio"/> College graduate <input type="radio"/> Post college	<input type="radio"/> African American <input type="radio"/> Asian American <input type="radio"/> Hispanic <input type="radio"/> Native American <input type="radio"/> Multi-racial <input type="radio"/> White/Caucasian	<input type="radio"/> Yes <input type="radio"/> No	<input type="radio"/> Yes <input type="radio"/> No
<input type="radio"/> Male <input type="radio"/> Female	<input type="radio"/> < 1 <input type="radio"/> 21-30 <input type="radio"/> 1-5 <input type="radio"/> 31-40 <input type="radio"/> 6-10 <input type="radio"/> 41-50 <input type="radio"/> 11-15 <input type="radio"/> 51-60 <input type="radio"/> 16-20 <input type="radio"/> 61+	<input type="radio"/> In school now <input type="radio"/> Some high school <input type="radio"/> High school grad <input type="radio"/> Some college <input type="radio"/> College graduate <input type="radio"/> Post college	<input type="radio"/> African American <input type="radio"/> Asian American <input type="radio"/> Hispanic <input type="radio"/> Native American <input type="radio"/> Multi-racial <input type="radio"/> White/Caucasian	<input type="radio"/> Yes <input type="radio"/> No	<input type="radio"/> Yes <input type="radio"/> No
<input type="radio"/> Male <input type="radio"/> Female	<input type="radio"/> < 1 <input type="radio"/> 21-30 <input type="radio"/> 1-5 <input type="radio"/> 31-40 <input type="radio"/> 6-10 <input type="radio"/> 41-50 <input type="radio"/> 11-15 <input type="radio"/> 51-60 <input type="radio"/> 16-20 <input type="radio"/> 61+	<input type="radio"/> In school now <input type="radio"/> Some high school <input type="radio"/> High school grad <input type="radio"/> Some college <input type="radio"/> College graduate <input type="radio"/> Post college	<input type="radio"/> African American <input type="radio"/> Asian American <input type="radio"/> Hispanic <input type="radio"/> Native American <input type="radio"/> Multi-racial <input type="radio"/> White/Caucasian	<input type="radio"/> Yes <input type="radio"/> No	<input type="radio"/> Yes <input type="radio"/> No
<input type="radio"/> Male <input type="radio"/> Female	<input type="radio"/> < 1 <input type="radio"/> 21-30 <input type="radio"/> 1-5 <input type="radio"/> 31-40 <input type="radio"/> 6-10 <input type="radio"/> 41-50 <input type="radio"/> 11-15 <input type="radio"/> 51-60 <input type="radio"/> 16-20 <input type="radio"/> 61+	<input type="radio"/> In school now <input type="radio"/> Some high school <input type="radio"/> High school grad <input type="radio"/> Some college <input type="radio"/> College graduate <input type="radio"/> Post college	<input type="radio"/> African American <input type="radio"/> Asian American <input type="radio"/> Hispanic <input type="radio"/> Native American <input type="radio"/> Multi-racial <input type="radio"/> White/Caucasian	<input type="radio"/> Yes <input type="radio"/> No	<input type="radio"/> Yes <input type="radio"/> No
<input type="radio"/> Male <input type="radio"/> Female	<input type="radio"/> < 1 <input type="radio"/> 21-30 <input type="radio"/> 1-5 <input type="radio"/> 31-40 <input type="radio"/> 6-10 <input type="radio"/> 41-50 <input type="radio"/> 11-15 <input type="radio"/> 51-60 <input type="radio"/> 16-20 <input type="radio"/> 61+	<input type="radio"/> In school now <input type="radio"/> Some high school <input type="radio"/> High school grad <input type="radio"/> Some college <input type="radio"/> College graduate <input type="radio"/> Post college	<input type="radio"/> African American <input type="radio"/> Asian American <input type="radio"/> Hispanic <input type="radio"/> Native American <input type="radio"/> Multi-racial <input type="radio"/> White/Caucasian	<input type="radio"/> Yes <input type="radio"/> No	<input type="radio"/> Yes <input type="radio"/> No
<input type="radio"/> Male <input type="radio"/> Female	<input type="radio"/> < 1 <input type="radio"/> 21-30 <input type="radio"/> 1-5 <input type="radio"/> 31-40 <input type="radio"/> 6-10 <input type="radio"/> 41-50 <input type="radio"/> 11-15 <input type="radio"/> 51-60 <input type="radio"/> 16-20 <input type="radio"/> 61+	<input type="radio"/> In school now <input type="radio"/> Some high school <input type="radio"/> High school grad <input type="radio"/> Some college <input type="radio"/> College graduate <input type="radio"/> Post college	<input type="radio"/> African American <input type="radio"/> Asian American <input type="radio"/> Hispanic <input type="radio"/> Native American <input type="radio"/> Multi-racial <input type="radio"/> White/Caucasian	<input type="radio"/> Yes <input type="radio"/> No	<input type="radio"/> Yes <input type="radio"/> No

Form 1137 (08-16)

Produced by Agricultural Communications.

We are an equal opportunity employer, and all qualified applicants will receive consideration for employment without regard to race, color, religion, sex, national origin, disability status, protected veteran status, or any other characteristic protected by law.

Extension Service of Mississippi State University, cooperating with U.S. Department of Agriculture. Published in furtherance of Acts of Congress, May 8 and June 30, 1914. GARY B. JACKSON, Director



### HOW TO TAKE A WELL WATER SAMPLE

- Wash your hands.
- Use a faucet as close to the well as possible for making the collection. If an inside faucet is used, remove the aerator on the end of the faucet before making the collection.
- Rinse and dry the exterior of the faucet to prevent exterior contamination of your water sample. If possible, clean with a disinfecting wipe or paper towel and light bleach solution to kill any bacteria present on the faucet. Allow the solution to dry before sampling.
- Turn on the water full force and let it run for 2 minutes.
- Reduce the water flow to a small stream.
- Tear off the protective seal. Unscrew the cap to open the bottle. Do not touch the inside of the bottle or the cap.
- **Do not affix any labels to the sample bottle. Do not remove, pour out, or rinse out the powder or pellets in the sample bottle.**
- Fill the bottle to the required fill line to ensure that 100 milliliters are collected.
- Screw the cap securely on the bottle to prevent leaking.

PLEASE NOTE: For best results, collect samples immediately before dropping them off but no more than 12 hours before.

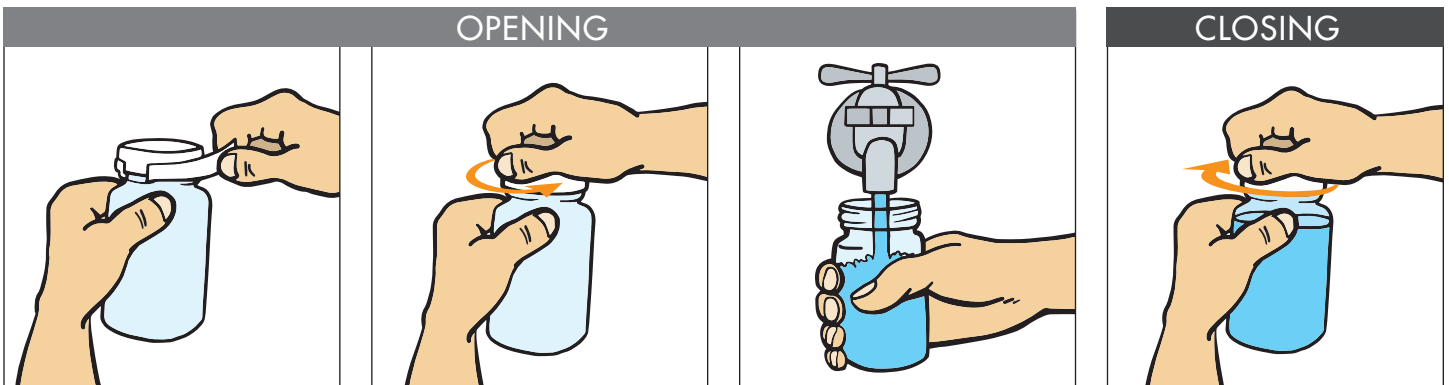

1.

Tear off the protective seal.

2.

Unscrew the cap to open the bottle. Do not touch the inside of the bottle or the cap.

3.

Fill bottle to the required fill line. The fill line will ensure that 100 ml are collected.

4.

Screw the cap securely on the bottle to prevent leaking.